

This PDF offers instructions on how to install Titan Hybrid flooring and Clix flooring on steps/staircases. Please ensure you follow the correct instructions.

Installing Titan Hybrid Flooring on stairs

The Titan Hybrid 'custom style' stair nosing provides a beautiful and durable stair solution. It is sold in 2.4m lengths in all Titan finishes for a professional finish for all stairs and landings. Installation is simple and versatile when following these Pro Installer Tips:

1. Treads and risers, except the plank on the top landing, are glued into position using a quality adhesive.

2. Fix the tread first. Once the glue is dry, the nosing can be brought into position and aligned as necessary.

3. The riser can be 'boxed out' for a vertical finish, or brought back on an angle, into the back of the tread. Please see diagram:

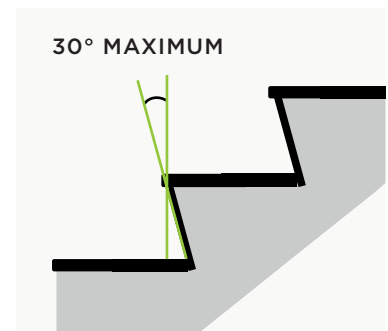

4. Always allow a gap between the nosing and any hybrid floor installed at the top of the stairs.

5. This gap can be covered using the matching connector and will allow the floor to expand or contract independently of the top nosing.

6. A resilient non-slip tread tape can be applied to further improve slip resistance.

Installing Clix Laminate Flooring on stairs



The Incizo® profile enables you to create stairs that fit perfectly into your interior.

Incizo®: Incizo® profile + subprofile for stairs

The subprofile for stairs:

- Aluminum alloy 6060 T66
- Non anodized aluminium, not chromated



INSTALLATION INSTRUCTIONS

Warning: Read and follow the safety instructions included with power tools used. Safety glasses should be worn at all times. Only for use in residential applications.

- Double-check you have ordered the correct aluminium subprofile for the floor of your choice.
- Clear the stairs of debris, making sure that all stairs are clean and level.
- Use screws of 2.5 mm diameter. Drill diameter should be 3 mm.

INSTALLATION INSTRUCTIONS

Staircase A



	<p>1. Start at the top of the stairs and work downwards.</p>
	<p>2. Prepare 2 spacers per stair tread. Important: the spacers should have a thickness of the floor you use, plus 2mm. This will enable you later to easily insert the tread plank under the stair riser plank.</p>
	<p>3. Measure the riser.</p>
	<p>4. Saw a plank to the right size. If needed, click 2 planks together and only saw the tongue of the upper plank.</p>
	<p>5. Apply glue to the plank.</p>
	<p>6. Put the plank against the riser. The groove should be behind the spacers. Repeat 1-6 for the rest of the stairs.</p>
	<p>7. Start at the top of the stairs and work downwards.</p>
	<p>8. Measure the tread.</p>

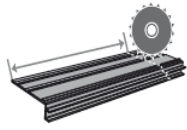

9. Saw the aluminium subprofile to the right length.

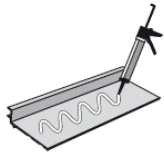

10. Apply glue to the bottom of the subprofile.

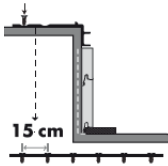

11. Install the subprofile on the tread. Screw it to the stairs, with an interval of 15 cm. Make sure the screws are well countersunk.

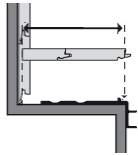

12. Saw a plank to the right size. If needed, click 2 planks together and only saw the groove of the last plank.



13. Cut off part A of the Incizo® with the Incizo® knife. See instructions included in Incizo® packaging.

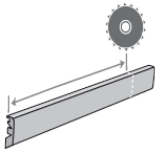

14. Saw the Incizo® profile to the right length.

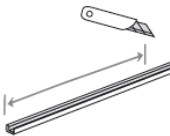

15. Depending on the type of subprofile you bought, it is supplied with or without a plastic insert. If a plastic insert is included, cut it to the correct length.*

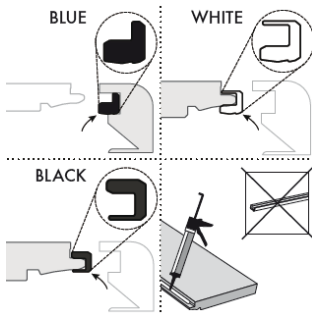

16. If insert included: way of installing depends on floor thickness, carry out as indicated on the illustration. If insert not included: apply glue to the tongue of the plank.*

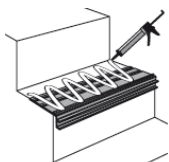

17. Apply glue to the subprofile and the rest of the tread. Apply in rows of +/- 3 mm.

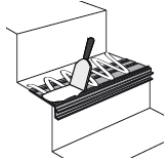

18. Spread the glue out well on the subprofile (e.g. by means of a brush). It is important to move to the next steps without delay, so the tread is still adjustable when installing the Incizo® profile.

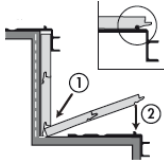

19. Install the tread plank. Do not press too firmly, so the plank does not tilt but stays nicely flat.

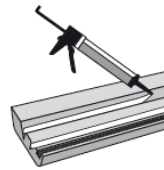

20. Apply glue on both sides of the Incizo® foot.

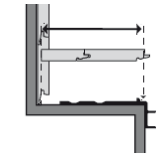

21. Stick the Incizo® profile horizontally onto the subprofile and adjust the Incizo® and the plank nicely for a level result. Repeat installation for the rest of the stairs.

AFTER INSTALLATION, DO NOT WALK ON THE STAIRS FOR AT LEAST 24 HOURS.

INSTALLATION INSTRUCTIONS

Staircase B



	<p>1. Start at the top of the stairs and work downwards.</p>
	<p>2. Prepare 2 spacers per stair tread. Important: the spacers should have a thickness of the floor you use, plus 2mm. This will enable you later to easily insert the tread plank under the stair riser plank.</p>
	<p>3. Measure the riser.</p>
	<p>4. Saw a plank to the right size. If needed, click 2 planks together and only saw the tongue of the upper plank.</p>
	<p>5. Apply glue to the plank.</p>
	<p>6. Put the plank against the riser. The groove should be behind the spacers. Repeat 1-6 for the rest of the stairs.</p>
	<p>7. Start at the top of the stairs and work downwards.</p>
	<p>8. Measure the tread.</p>

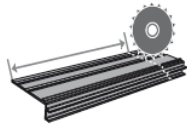

9. Saw the aluminium subprofile to the right length.

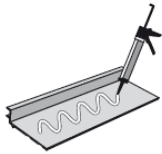

10. Apply glue to the bottom of the subprofile.

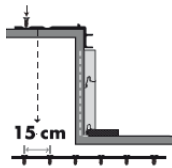

11. Install the subprofile on the tread. Screw it to the stairs, with an interval of 15 cm. Make sure the screws are well countersunk.

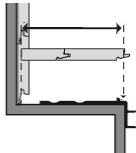

12. Saw a plank to the right size. If needed, click 2 planks together and only saw the groove of the last plank. *For Type C, saw the riser plank like this.*

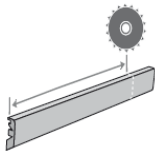

13. Saw the Incizo® profile to the right length.

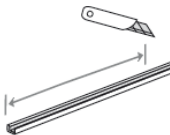

14. Depending on the type of subprofile you bought, it is supplied with or without a plastic insert. If a plastic insert is included, cut it to the correct length.*

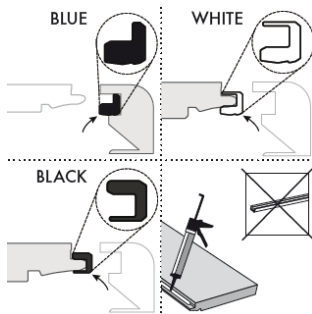

15. If insert included: way of installing depends on floor thickness, carry out as indicated on the illustration. If insert not included: apply glue to the tongue of the plank.*

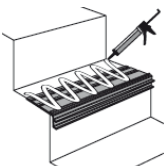

16. Apply glue to the subprofile and the rest of the tread. Apply in rows of +/- 3 mm.

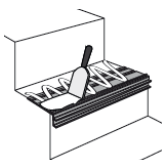

17. Spread the glue out well on the subprofile (e.g. by means of a brush). It is important to move to the next steps without delay, so the tread is still adjustable when installing the Incizo® profile.

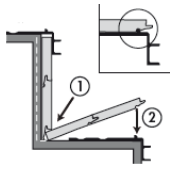

18. Install the tread plank. Do not press too firmly, so the plank does not tilt but stays nicely flat. *For Type C, install the riser plank like this.*



19. Apply glue on both sides of the Incizo® foot.

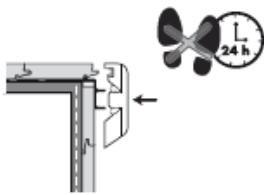

20. Stick the Incizo® profile horizontally onto the subprofile and adjust the Incizo® and the plank nicely for a level result. Repeat installation for the rest of the stairs.

AFTER INSTALLATION, DO NOT WALK ON THE STAIRS FOR AT LEAST 24 HOURS.

INSTALLATION INSTRUCTIONS

Staircase C

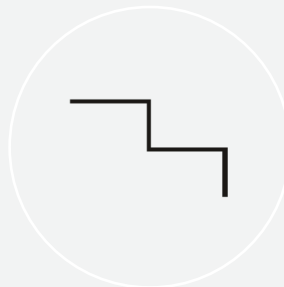

In certain cases an expansion joint is required: transition to a lower part of a room by means of a tread, transition to another type of floor at the top of the staircase.

Obligatory non-flush installation of the Incizo® stair profile to cover an expansion joint.



SEE INSTALLATION INSTRUCTIONS STAIRCASE B.

INSTALLATION INSTRUCTIONS

Staircase D

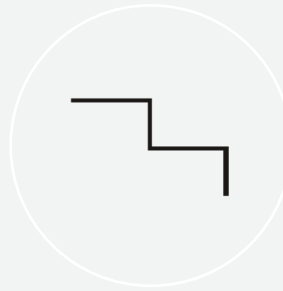

	<p>1. Start at the top of the stairs and work downwards.</p>
	<p>2. Measure the riser.</p>
	<p>3. Saw the aluminium subprofile to the right length.</p>
	<p>4. Apply glue to the bottom of the subprofile.</p>
	<p>5. Install the subprofile on the tread. Screw it to the stairs, with an interval of 15 cm. Make sure the screws are well countersunk.</p>
	<p>6. Saw a plank to the right size. If needed, click 2 planks together and only saw the groove of the last plank.</p>
	<p>7. Saw the Incizo® profile to the right length.</p>
	<p>8. Depending on the type of subprofile you bought, it is supplied with or without a plastic insert. If a plastic insert is included, cut it to the correct length.*</p>

	<p>9. If insert included: way of installing depends on floor thickness, carry out as indicated on the illustration. If insert not included: apply glue to the tongue of the plank.*</p>
	<p>10. Apply glue to the subprofile and the rest of the tread. Apply in rows of +/- 3 mm.</p>
	<p>11. Spread the glue out well on the subprofile (e.g. by means of a brush). It is important to move to the next steps without delay, so the tread is still adjustable when installing the Incizo® profile.</p>
	<p>12. Install the tread plank. Do not press too firmly, so the plank does not tilt but stays nicely flat.</p>
	<p>13. Apply glue on both sides of the Incizo® foot.</p>
	<p>14. Stick the Incizo® profile horizontally onto the subprofile and adjust the Incizo® and the plank nicely for a level result. Repeat installation for the rest of the stairs.</p>

AFTER INSTALLATION, DO NOT WALK ON THE STAIRS FOR AT LEAST 24 HOURS.

INSTALLATION INSTRUCTIONS

Staircase E

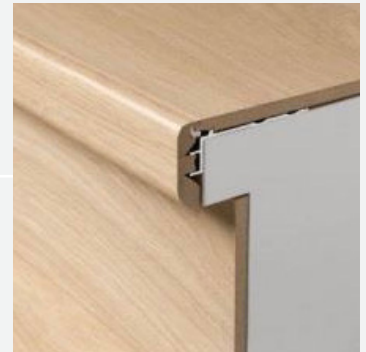
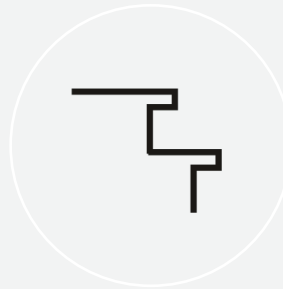

	<p>1. Start at the top of the stairs and work downwards.</p>
	<p>2. Prepare 2 spacers per stair tread. Important: the spacers should have a thickness of the floor you use, plus 2mm. This will enable you later to easily insert the tread plank under the stair riser plank.</p>
	<p>3. Measure the riser.</p>
	<p>4. Saw a plank to the right size. If needed, click 2 planks together and only saw the tongue of the upper plank.</p>
	<p>5. Apply glue to the plank.</p>
	<p>6. Put the plank against the riser. The groove should be behind the spacers. Repeat 1-6 for the rest of the stairs.</p>
	<p>7. Start at the top of the stairs and work downwards.</p>
	<p>8. Measure the tread.</p>

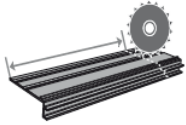

9. Saw the aluminium subprofile to the right length.

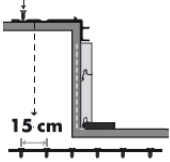

10. Install the subprofile on the tread. Screw it to the stairs, with an interval of 15 cm. Make sure the screws are well countersunk.

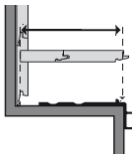

11. Saw a plank to the right size. If needed, click 2 planks together and only saw the groove of the last plank.

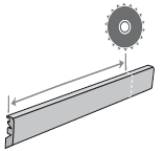

12. Saw the Incizo® profile to the right length.

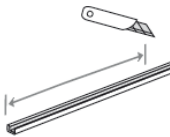

13. Depending on the type of subprofile you bought, it is supplied with or without a plastic insert. If a plastic insert is included, cut it to the correct length.*

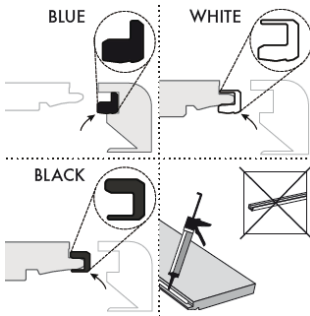

14. If insert included: way of installing depends on floor thickness, carry out as indicated on the illustration. If insert not included: apply glue to the tongue of the plank.*

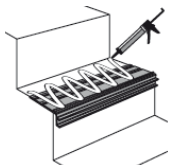

15. Apply glue to the subprofile and the rest of the tread. Apply in rows of +/- 3 mm.

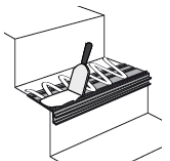

16. Spread the glue out well on the subprofile (e.g. by means of a brush). It is important to move to the next steps without delay, so the tread is still adjustable when installing the Incizo® profile.

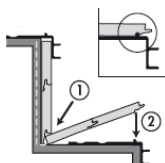

17. Install the tread plank. Do not press too firmly, so the plank does not tilt but stays nicely flat.

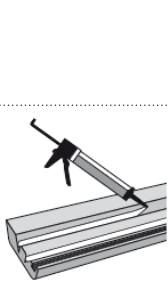

18. Apply glue on both sides of the Incizo® foot.

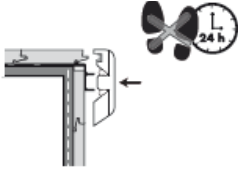

19. Stick the Incizo® profile horizontally onto the subprofile and adjust the Incizo® and the plank nicely for a level result. Repeat installation for the rest of the stairs.

AFTER INSTALLATION, DO NOT WALK ON THE STAIRS FOR AT LEAST 24 HOURS.

INSTALLATION INSTRUCTIONS

Staircase E

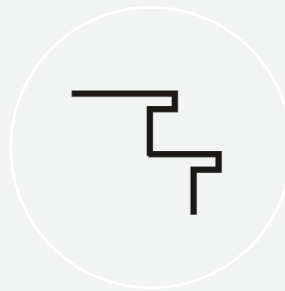

	<p>1. Start at the top of the stairs and work downwards.</p>
	<p>2. Measure the tread.</p>
	<p>3. Saw the aluminium subprofile to the right length.</p>
	<p>4. Apply glue to the bottom of the subprofile.</p>
	<p>5. Install the subprofile on the tread. Screw it to the stairs, with an interval of 15 cm. Make sure the screws are well countersunk.</p>
	<p>6. Saw a plank to the right size. If needed, click 2 planks together and only saw the groove of the last plank.</p>
	<p>7. Saw the Incizo® profile to the right length.</p>
	<p>8. Depending on the type of subprofile you bought, it is supplied with or without a plastic insert. If a plastic insert is included, cut it to the correct length.*</p>

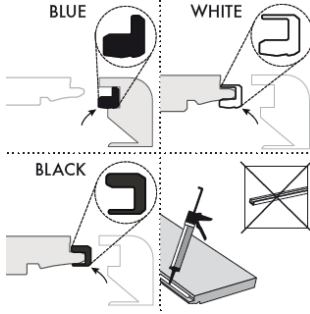
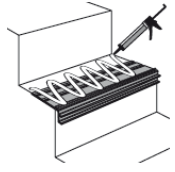
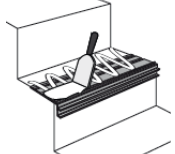
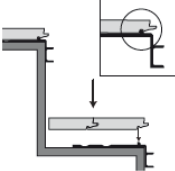
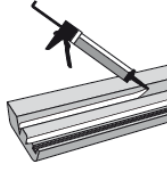
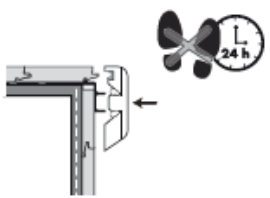
	<p>9. If insert included: way of installing depends on floor thickness, carry out as indicated on the illustration. If insert not included: apply glue to the tongue of the plank.*</p>
	<p>10. Apply glue to the subprofile and the rest of the tread. Apply in rows of +/- 3 mm.</p>
	<p>11. Spread the glue out well on the subprofile (e.g. by means of a brush). It is important to move to the next steps without delay, so the tread is still adjustable when installing the Incizo® profile.</p>
	<p>12. Install the tread plank. Do not press too firmly, so the plank does not tilt but stays nicely flat.</p>
	<p>13. Apply glue on both sides of the Incizo® foot.</p>
	<p>14. Stick the Incizo® profile horizontally onto the subprofile and adjust the Incizo® and the plank nicely for a level result. Repeat installation for the rest of the stairs.</p>

AFTER INSTALLATION, DO NOT WALK ON THE STAIRS FOR AT LEAST 24 HOURS.

Side Finishing

To finish off the sides of the stairs we recommend using laminated sheets. These are available for sale in most specialty retail or DIY stores. Laminated sheets are about 0,7 - 0,9 mm and available in different colors. They can be applied to the side of the stairs with contact glue. An alternative solution could be to finish off the sides of the stairs with MDF.