



Karndean
Designflooring



Karndean
LooseLay

Karndean LooseLay

Home



Dover LLP03 ▾

Country Oak VGW92T-7LLST ▾



Boston LLP111 ▾

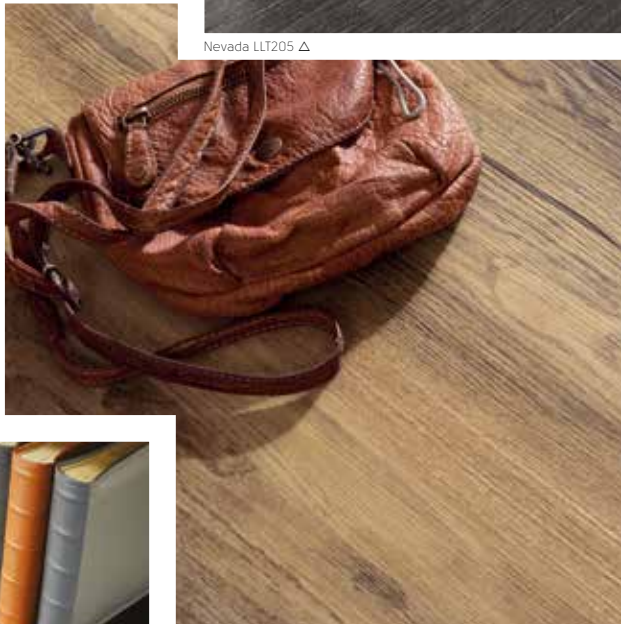

Nevada LLT205 ▾



Burlington LLP110 ▾



Hudson LLP09 ▾



Stamford LLP109 ▾



Texas LLT207 ▾



Colorado LLT201 ▾



Madison LLT203 ▾



Stamford LLP109 ▾



Arizona LLT200 ▾

Why Karndean LooseLay?



Quick and easy to install

With its unique friction grip K-Wave backing, Karndean LooseLay is quick and easy to install.

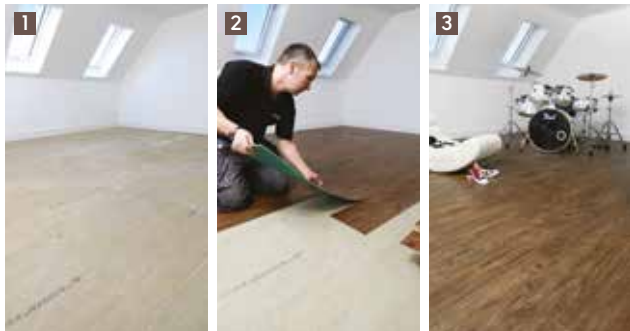

Individually replaceable

If a plank or tile is damaged, LooseLay is very easy to lift and replace.



Reduces noise transfer

Reduces noise transfer to rooms below, making it perfect for upstairs bedrooms, playrooms or attic/loft conversions, as well as multifamily or office blocks.



Comfortable underfoot

Our products are much warmer and quieter underfoot, giving you the look of real wood and stone but without the drawbacks of cold tiles or clicking shoes.



Realistic designs

The most realistic designs. Inspired by nature, our products are designed in-house and realistically replicate the look and feel of real wood and stone materials.



Compatible with underfloor heating

Up to 27°C



100% recyclable



Durable

Compared to other flooring alternatives, Karndean gives you the look and feel of natural products but with the durability and resilience of luxury vinyl.



Low maintenance

A regular sweep and mop with Karndean Clean is all you need to keep your Karndean floor looking great. With Karndean, you also don't have to worry about any sanding, refinishing, staining or varnishing.

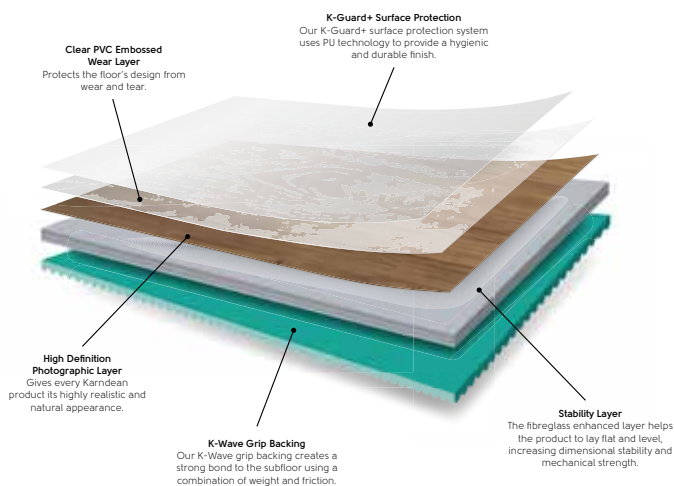

*Adhesive may be required for some applications, please refer to installation instructions.





Karndean LooseLay Wood

1050mm x 250mm (41.3" x 9.85")



Waterbury **LLP152** (Series Four) pg 29



Brockton **LLP153** (Series Four) pg 31



Ashland **LLP95** (Series Two) pg 12



Bridgeport **LLP157** (Series Four) pg 31



Hudson **LLP99** (Series Two) pg 15



Danbury **LLP154** (Series Four) pg 30



Fairfield **LLP155** (Series Four) pg 28



Newport **LLP94** (Series Two) pg 13



Stamford **LLP109** (Series Three) pg 22



Country Oak **VGW92T-7LLST** (Series One) pg 6



Hartford **LLP112** (Series Three) pg 24



Boston **LLP111** (Series Three) pg 25



Burnt Ginger **VG5-7LLST** (Series One) pg 7



Merbau **VGW91T-7LLST** (Series One) pg 8



Hamden **LLP156** (Series Four) pg 31



Cambridge **LLP113** (Series Three) pg 20



Providence **LLP108** (Series Three) pg 21



Tasmanian Wattle **VGW38T-7LLST** (Series One) pg 9



Winchester **LLP97** (Series Two) pg 14



Antique Karri **VGW39T-7LLST** (Series One) pg 9



Copper Gum **VGW33T-7LLST** (Series One) pg 9



Burlington **LLP110** (Series Three) pg 23



Salem **LLP96** (Series Two) pg 16



Dover **LLP93** (Series Two) pg 17

Karndean LooseLay Stone

500mm x 610mm (19.7" x 24")



Maine **LLT213** (Series Four) pg 29



Indiana **LLT202** (Series One) pg 28



Georgia **LLT206** (Series Two) pg 34



Colorado **LLT201** (Series One) pg 29

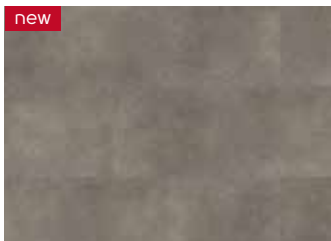

Dakota **LLT212** (Series Four) pg 29



Texas **LLT207** (Series Two) pg 35



Arizona **LLT200** (Series One) pg 30



Madison **LLT203** (Series One) pg 31

Karndean LooseLay Textile

500mm x 610mm (19.7" x 24")



Pennsylvania **LLT204** (Series Two) pg 38



Nevada **LLT205** (Series Two) pg 39

Colour and Pattern Reproduction

We are careful to make sure our brochures are accurate and printed to very high standards, but photography and printing cannot always create a perfect representation of our products. For this reason we strongly recommend that you look at a sample of any product you are considering before placing your order.

All of our products are inspired by things we have seen in the natural world. Just as variation in colour and detail is part of the unique beauty of natural materials, it is also a feature of many of our designs. This means that with some of our products you will see natural variation when your floor is laid. If in doubt, ask your retailer to show you a larger sample of the product.

We love developing new ideas and improving on our existing designs. This does mean that sometimes products are withdrawn at short notice. We hate to disappoint, and will always try to work with you to find an alternative design that you love just as much.

Series One Wood

1050mm x 250mm (41.3" x 9.85")



Our Series One collection introduces a palette of popular warm wood tones, from light Country Oak to the rich depth of Merbau.



Country Oak **VGW92T-7LLST**

Create a contemporary and open look in your room with the **cool grey hues and rustic grain details** of our Country Oak Karndean LooseLay planks.



Country Oak VGW92T-7LLST





Burnt Ginger VG5-7LLST

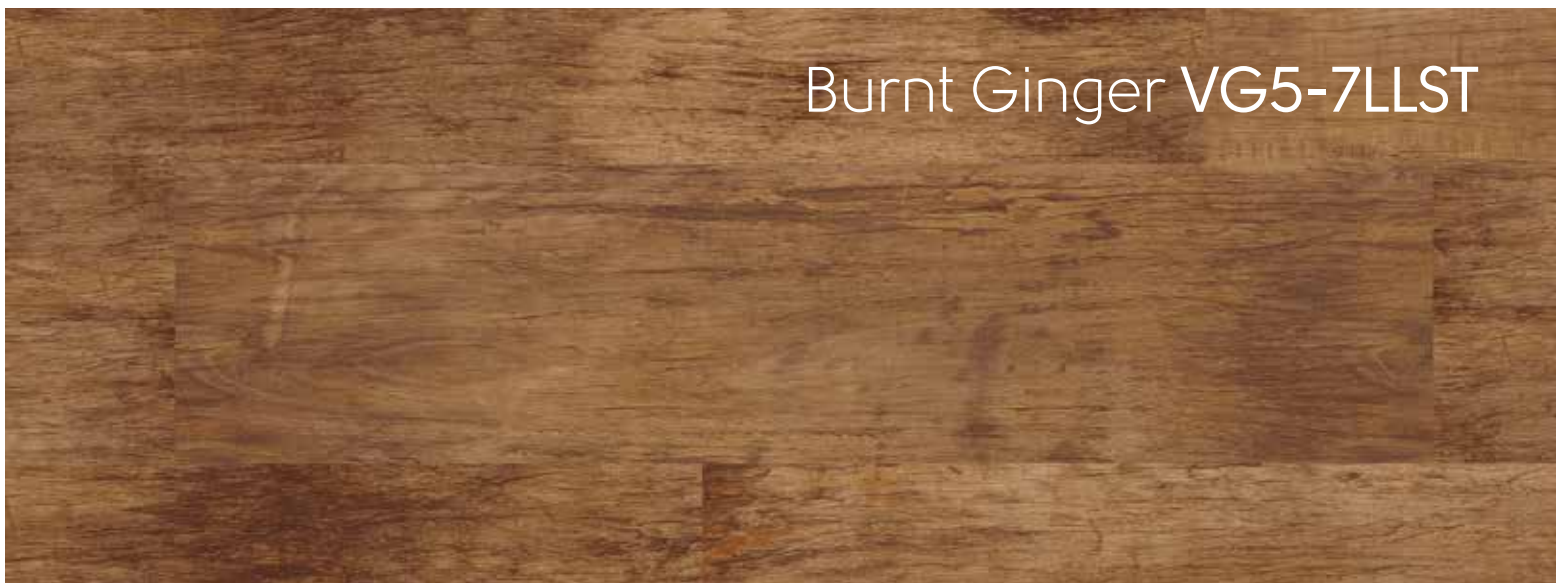



Merbau VGW91T-7LLST

more designs available in the
Series One Wood range...



Tasmanian Wattle VGW38T-7LLST

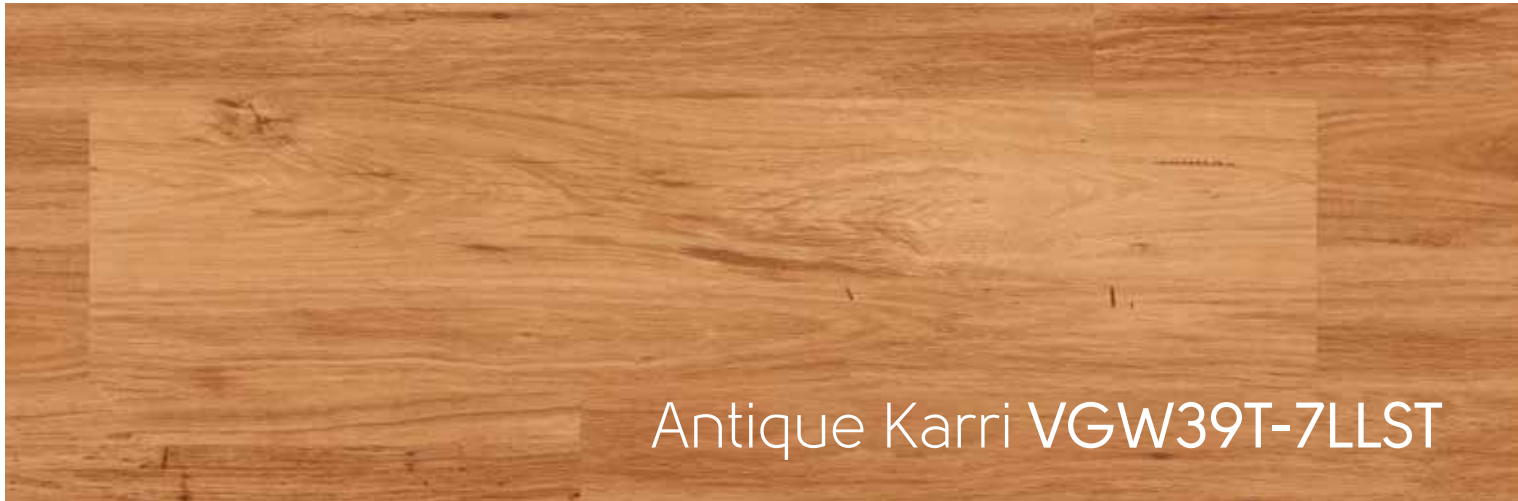

Antique Karri VGW39T-7LLST



Copper Gum VGW33T-7LLST

Series Two Wood

1050mm x 250mm (41.3" x 9.85")



Our Series Two wood designs reflect the trend for delicate oak, worn wood and distressed patterns.



Dover **LLP93**

The **wide planks and rich chocolate tones** of our Karndean LooseLay Dover planks will help create an inviting and contemporary open look in your room.



Ashland LLP95





Newport LLP94



Winchester LLP97





Hudson LLP99



Salem LLP96





Dover LLP93

Series Three Wood

1050mm x 250mm (41.3" x 9.85")



Our Series Three collection includes popular pale and warm oak tones, fashionable rustics and deep greys.



Boston **LLP111**

You can instantly transform a neutral room with the **rich chocolate brown hues** in our Boston planks. Pair with metallic finishes and classic vintage pieces for a luxurious look.



Cambridge LLP113





Providence LLP108



Stamford LLP109





Burlington LLP110



Hartford LLP112





Boston LLP111



Series Four Wood

1050mm x 250mm (41.3" x 9.85")



Our Series Four designs feature oaks in cool contemporary tones from pale greys to ashy browns.



Danbury **LPI154**

The naturally harmonised hues of Danbury make it a great option for any interior space.



Fairfield LLPI55





Waterbury LLPI52



Danbury LLP154

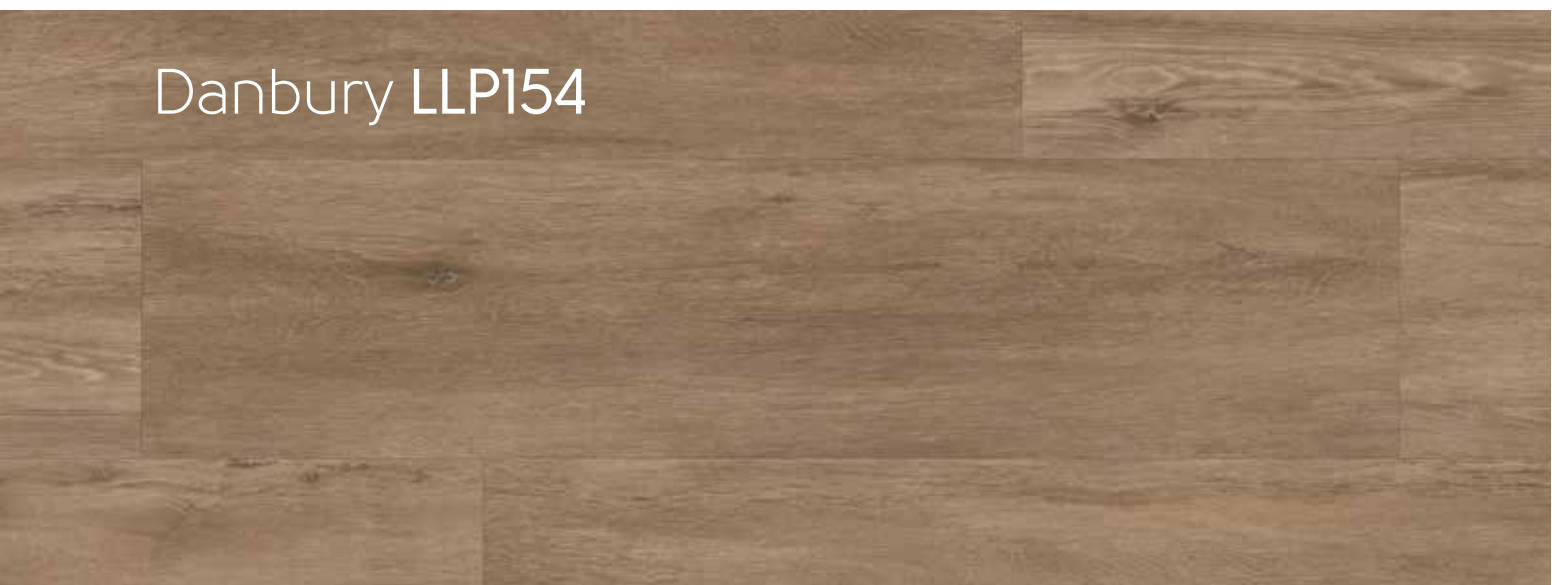

more designs available in the
Series Four Wood range...

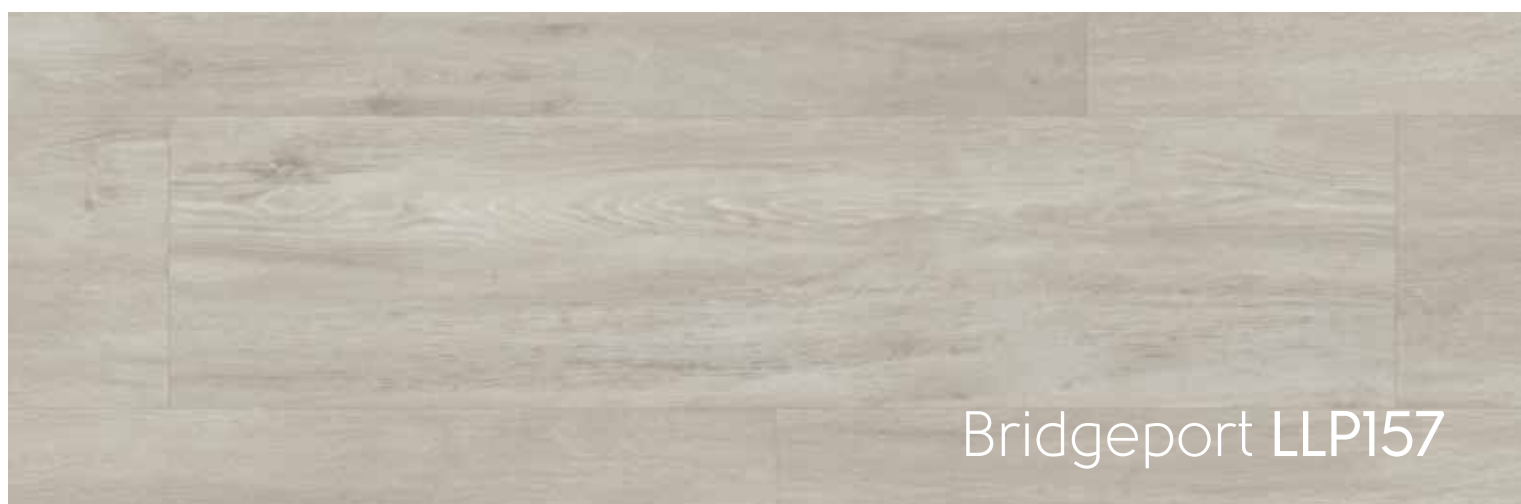

Series One Stone

500mm x 610mm (19.7" x 24")





Our Series One stone collection includes two modern mid-grey designs as well as cream and black travertine effect tiles.

Arizona **LLT200**

With the modern look of **sealed concrete**, our **mid-brown Arizona tiles** make a great base for any decor scheme.



Indiana LLT202



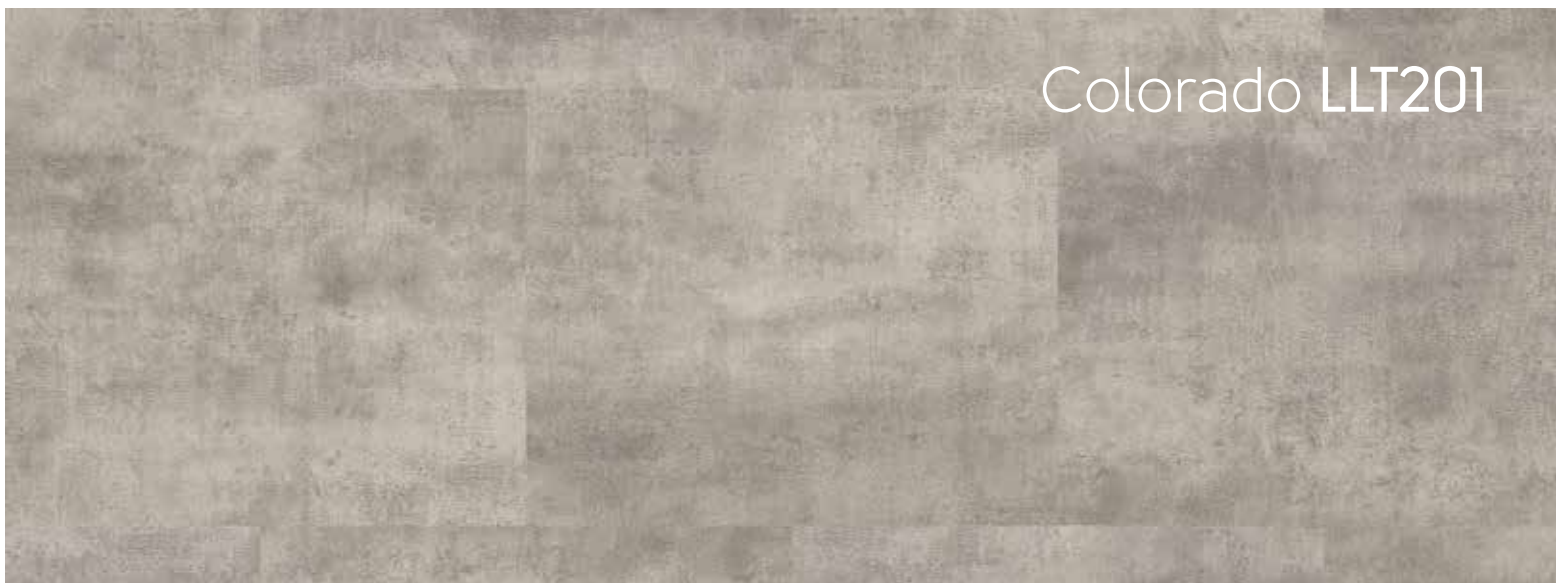

Colorado LLT201



Arizona LLT200





Madison LLT203

Series Two Stone

500mm x 610mm (19.7" x 24")



Our Series Two stone designs replicate the striking look of natural slate.



Texas **LLT207**

The darkest of our new slate designs, Texas features **warm dark brown tones** and looks great with both traditional and more modern decor styles.



Georgia LTT206





Texas LLT207

Series Four Stone

500mm x 610mm (19.7" x 24")



Our Series Four stones feature a subtle, neutral design in two contemporary, elegant colours.



Dakota **LLT212**

Create a contemporary look with Dakota. Taking inspiration from natural slate, you can easily give your space a modern look, without the impracticalities of real stone.



Maine LLT213





Dakota LLT212

Series Two Textile

500mm x 610mm (19.7" x 24")





Our Series Two textile designs feature a linear pattern for a distinct modern look.

Nevada LLT205

Nevada's **smoky charcoal tones** pair perfectly with clean white modern furnishings and pastel colours.



Pennsylvania LLT204



Nevada LLT205

Where can you buy Karndean LooseLay?

We want buying a Karndean floor to be as enjoyable and stress free as possible. To help us do this we have a Karndean showroom in Melbourne and over 1,100 retail partners in Australia and New Zealand on hand to work with you to design a beautiful floor for your home.

Visiting our showroom or one of our retail partners is the perfect way look at all of the designs, speak to a flooring expert, and see the unique friction grip backing in action. You'll also be able to take home Karndean LooseLay samples so you can match it to the colours in your home, giving you complete confidence you've picked the perfect floor.

To find your local Karndean retailer, simply visit our website at www.karndean.com/findaretailer. You'll be able to select a retailer of your choice and arrange for them to contact you.

As soon as your Karndean LooseLay floor is installed, your Karndean guarantee will begin, giving you peace of mind that your floor will look beautiful for years to come.

AUS: 1800 428 963
NZ: 0800 442 101

customerservice@karndean.com.au
customerservice@karndean.co.nz

www.karndean.com

Head Office & Showroom
835 Stud Road Knoxfield,
Victoria 3180





Country Oak VGW92T-7LLST ▽



Dover LLP93 ▽



Nevada LLT205 ▽

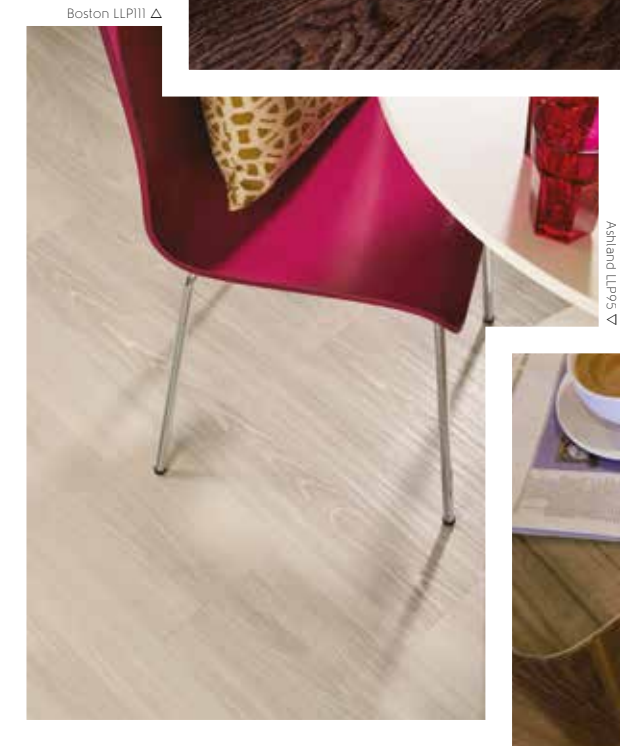

Ashland LLP95 ▽



Cambridge LLP13 ▽



Newport LLP94 ▽



Dover LLP93 ▽



Hartford LLP12 ▽



Stamford LLP109 ▽



Texas LLT207 ▽





Contact us...

Karndean Designflooring Australia
835 Stud Road Knoxfield VIC 3180
Tel: 1800 428 963*
customerservice@karndean.com.au

Karndean Designflooring New Zealand
Tel: 0800 442 101*
customerservice@karndean.co.nz

www.karndean.com

*Calls may be recorded for training and quality purposes.

Front cover image: Danbury **LLP154** | This page: Maine **LLT213**



Karndean
Designflooring



Australia



New Zealand

Karndean
LooseLay

Follow us online and see
what we've been up to:

